

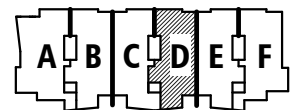

Spruce Slopeside

Mt. Mansfield

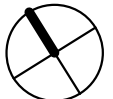

3 Bedroom + Bonus Room  
 Total Area: 2,468 SQ FT  
 Balcony Area: 113 SQ FT

TYP. RESIDENCE D



## Residence 3D Features List:

### General

- 3 Bedroom Residence + Bonus Room, 2,468 square feet on one floor and 113 square feet of balcony space in two distinct locations
- 1 balcony adjacent to the great room and another Juliette balcony off the master bedroom
- In-residence elevators begin at the garage/village/ski slope level and go directly to residence entry foyer on the third floor
- Views of Mt. Mansfield (tallest mountain in Vermont) and the Spruce Peak ski slopes
- Ashley Norton hardware
- Custom Vermont-made pendent lighting
- Radiant heating throughout residence
- Smart home system enabling owners to control heating, lighting, security cameras and more from anywhere

### Great Room and Foyer

- 9'-6" ceilings
- Oak wood floors and ceilings
- Gas fire place with granite hearth stone and metal mantel
- Floor-to-ceiling windows in great room
- Bluestone floor in foyer

### Kitchen

- Miele, Bosch and Bertazzoni appliances
- Buffet with wine cooler and antique mirror
- Extra-large Whirlpool front loading washer/dryer
- Oak wood floors
- Oak kitchen cabinetry and panelized appliance veneer
- Danby, VT Imperial marble countertops
- Reclaimed chestnut farm table kitchen islands
- 9'-6" ceilings

### Bedrooms

- Oak wood floors and accent walls in master
- 100% wool, hand loomed carpet in guest bedrooms

### Bathrooms

- Danby, VT Montclair marble in master bathroom
- Large soaking tub in master bath
- Kohler plumbing fixtures
- Bluestone in master bathroom

